

LED Mission Sconce Light with Metal Accents

Item# X72L41817SRBAFX

Features:

- Half round wall mount sconce is ADA compliant
- High quality decorative extruded aluminum bands
- Open top and bottom for wall wash effect
- Fixture mounts to standard junction box (not included)

Construction:

- Back plate is die-formed of 22-gauge steel
- Decorative bands are .060" extruded aluminum with an apparent thickness of .100" that are screwed to a 22-gauge back plate
- Standard mounting holes and hardware are included
- Power supply connections must be made inside a junction box (not included)

Finish:

- Back plate and bands are finished in satin nickel and oil-rubbed bronze

Electrical:

- This unit is direct wired with a constant current LED driver rated for 120-277V
- Compatible with residential (TRIAC/ELV) and commercial (0-10V) dimmers
- TRIAC and ELV dimming only at 120VAC

Certification:

- All fixtures are cULus listed for damp locations
- Lamping: (Fixture includes an LED module producing: 2700K or 3000K)
- 15W = 1400 source lumens
- 23W = 2100 source lumens
- Rated for 50,000 hrs., 90 CRI

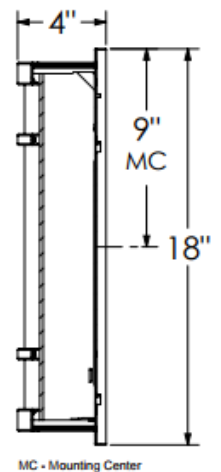
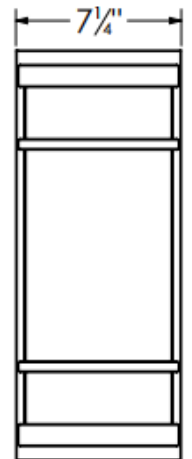

Toll Free 1.877.706.4480 | Local/ International 713.706.4480 | Fax 713.706.4161
www.MSEC.co

Warranty:

- Limited factory warranty 5 years

Ordering Specifications:

Satin Nickel	Oil-Rubbed Bronze	LED	Source Lumens	CCT	H	W	D
NSDU72L0041817SRBAFX	BRDU72L0041817SRBAFX	15W	1400	2700K	18"	7-1/4"	4"
NSDU03L0041817SRBAFX	BRDU03L0041817SRBAFX	15W	1400	3000K	18"	7-1/4"	4"
NSDU72L0012817SRBAFX	BRDU72L0012817SRBAFX	23W	2100	2700K	18"	7-1/4"	4"
NSDU03L0012817SRBAFX	BRDU03L0012817SRBAFX	23W	2100	3000K	18"	7-1/4"	4"

