

## Undercounter Laboratory Refrigerator



PR-L2460W-PA

Panasonic's under the counter or bench top scientific grade laboratory refrigerators are specifically designed to optimize cold storage for a variety of research applications.

**1. Space-Saving Design**—Compact size meets ADA compliance with easy installation under the counter or on a counter top.

**2. Temperature Uniformity**—The large evaporator surface under-counter achieves temperature uniformity at a designated set point

between 2°C to 8°C large evaporator surface.

**3. Design Versatility** —Reversible door option, clean lock design, and top lock allow for greater freedom of set-up and quick access when needing to retrieve materials.

Space-Saving Design



Temperature Uniformity



Secure & Easy Access



2.3 cu.ft. (65 liters)



### Compliant Height

Allows for easy installation under the counter, on a counter top, or within the knee-well of laboratory cabinetry. Units can be stacked and secured with stacking plates.



### Temperature Uniformity

Panasonic undercounter refrigerators feature state-of-the-art compressor technology. A large evaporator surface helps maintain precise temperature for research material.



### Secure & Easy Access

With clean lock design, under-counter refrigerators are made with lock on top for secure storage and reversible doors perfectly versatile for quick access of samples.

Inner Lock Mechanism

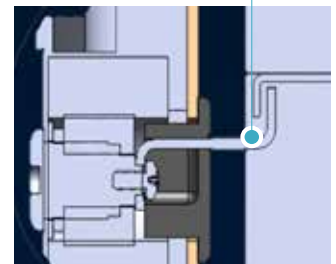

# Undercounter Laboratory Refrigerator

PR-L2460W-PA

Optimized for space-savings and cold storage. Panasonic undercounter refrigerators are ideal for the demanding standards of laboratory applications that need a precise and uniform environment.



MODEL	PR-L2460W-PA
ACCESS PORT	Right Side Top
CLEARANCE	Minimum recessed clearance: 3" (left side), 3" (right side), 6.88" (top), 4" (back)
DEFROST TYPE	Manual
DOOR LOCK	Standard Lock on Top
EXTERIOR DIMENSIONS (W X D X H)	18.6" x 19.9" x 25.2" (472 x 505 x 640mm)
EXTENDED SHELVES	2 Extended L-Shape Shelves
FLAT DOOR LINER	Standard Flat Door Liner
HINGE TYPE	Standard Stainless Steel Hinge
INTERNAL CAPACITY & VOLUME	2.3 cu.ft. (65 L)
PERFORMANCE CONDITIONS	24°C Ambient Temperature with 55% Humidity
REVERSIBLE DOOR	Standard
TEMPERATURE CONTROL	Manual with Temperature Lock Function
TEMPERATURE CONTROL RANGE	2°C - 8°C, varies in Ambient Temperature (24°C) with 55% Humidity
UL RATING	UL471 Commercial Rating